

150 ~ 200 Watts Single Output AC-DC U-bracket Type Medical Power

FEATURES

- 3 x 5 inch footprint with 1.5 inch low profile
- Operation altitude up to 5000meters
- Inhibit - TTL high to disable output
- Power Factor 0.98 typical
- Less than 220uA leakage current
- EN55011/55022 class B emissions
- Power Fail Detect(PFD) signal (optional)
- BF Class insulation

SPECIFICATIONS

Input Voltage	90-264 VAC
Input Frequency	47-63Hz
Input Current	2.5A max.
Inrush Current	20A/115VAC or 40A/230VAC at 25°C cold start
Earth Leakage/Touch Current	220uA/100uA max. at 264 VAC/63Hz
Line regulation	0.5% max. at full load
Remote Sense	Compensation for cable losses up to 0.5V
Withstand voltage	5656VDC from input to output
Hold Up Time	10ms min. at 110VAC
Operating Temperature	0 to +70°C
Derating from 100% at +50°C linearly to 50% at +70°C	
Storage Temperature / Humidity	-40 to +85°C / 5% to 95%
Fan Power	12V at 250mA max.
Safety Standard	UL ES 60601-1/CSA-C22.2 No. 60601-1, CE
EMC Standard	EN55011, EN55022 class B
	EN61000-3-2,3, EN61000-4-2,3,4,5,6,8,11

All specifications are typical at nominal line, full load and 25°C; unless otherwise noted.



Model Number	Output Voltage	Output Current			Output Max. Watts	EFF. 115V/230V
		min.	convection	5.3CFM		
FPM202-S120-z	12VDC	0.1A	12.5A	16.67A	150W/200W	88/91%
FPM202-S150-z	15VDC	0.1A	10.0A	13.34A	150W/200W	88/91%
FPM202-S180-z	18VDC	0.1A	8.34A	11.12A	150W/200W	88/91%
FPM202-S240-z	24VDC	0.1A	6.25A	8.34A	150W/200W	88/91%
FPM202-S280-z	28VDC	0.1A	5.36A	7.15A	150W/200W	88/91%
FPM202-S320-z	32VDC	0.1A	4.69A	6.25A	150W/200W	88/91%
FPM202-S360-z	36VDC	0.1A	4.17A	5.56A	150W/200W	88/92%
FPM202-S480-z	48VDC	0.1A	3.13A	4.17A	150W/200W	89/92%

Notes:

1. Z = U for U-Bracket; Z = E for Enclosed
2. 150 W without moving air or 200 W with 5.3 CFM forced air provided by user for "U" version, 200W for "E" version with cover and fan assembly. The adequacy of cooling air is judged by the measured core temperature of transformer T1 below 75°C at 25°C ambient, or below 100°C at 50°C ambient.
3. Ripple and noise is maximum peak to peak voltage value measured at output within 20MHz bandwidth, at rated line voltage and output load ranges and with a 10 μ F tantalum capacitor in parallel with a 0.1 μ F ceramic capacitor across the output.
4. All models may be operated at no-load without damage. At no load, output voltage fluctuates beyond 5% due to the burst-mode operation of the control IC in them for energy saving.

MECHANICAL DRAWING (Unit: mm)

U-bracket Form

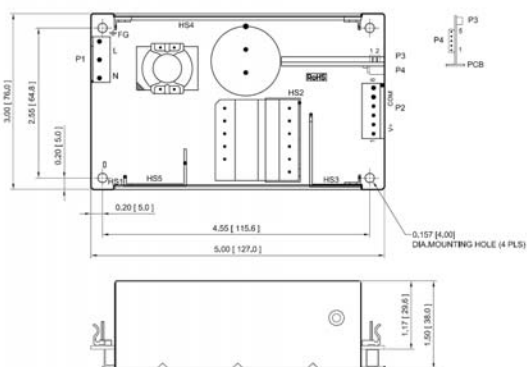

Enclosed Form

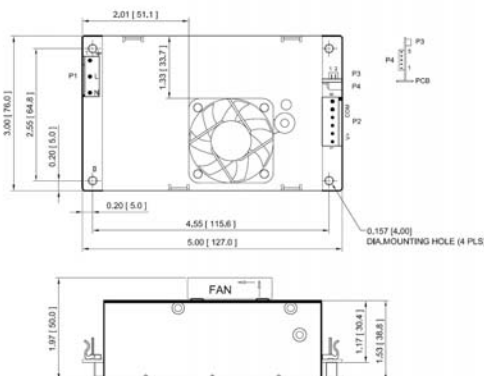

NOTES:

1. Dimensions shown in inches [mm]
2. Tolerance 0.02 [0.5] maximum
3. Input connector P1: Molex header 09-65-2058 or equivalent, mating with Molex housing 09-50-1051 or equivalent.
4. Output connector P2: Molex header 09-65-2068 or equivalent, mating with Molex housing 09-50-1061 or equivalent.
5. Fan connector P3: JST header S2B-ZR-3.4 or equivalent, mating with JST housing ZHR-2 or equivalent.
6. Connectors P4: Molex header 22-05-7055 or equivalent, mating with Molex housing 50-37-5053 or equivalent.
7. Weight: 390 grams (0.86 lbs.) approx. for U-bracket form, 440 grams (0.97 lbs.) for enclosed form
8. Fixing of units to end equipment is through standoffs and the four mounting holes in PCB.
9. Ground tab is 0.25 [6.35] x 0.032 [0.8] fast-on connector.

PIN CHART

Connector	P1					P2					
PIN NO.	1	2	3	4	5	1	2	3	4	5	6
Polarity	Ground	Void	Live	Void	Neutral	+V1			Common Return		

Connector	P3		P4				
PIN NO.	1	2	1	2	4	5	
Polarity	+12V Fan	Common Return	-Sense	+Sense	PFD	Inhibit	Common Return